

Daily Itinerary for 2026 Mexico: Myths, Metropoles and the Magical Group Study Program

Pre departure activities

| Date | Activity | Comments |
|-----------|--|--------------------------------------|
| MON May 4 | Mexico: MMM Program Overview + Mexico General Orientation | Instructor Presentation |
| THU May 7 | Term Project Pin-Ups + Group Discussion | Work Session Day |
| FRI May 8 | Pre-Departure Detailed Orientation and Student Term Project Sketch Presentations | Instructor and Student Presentations |

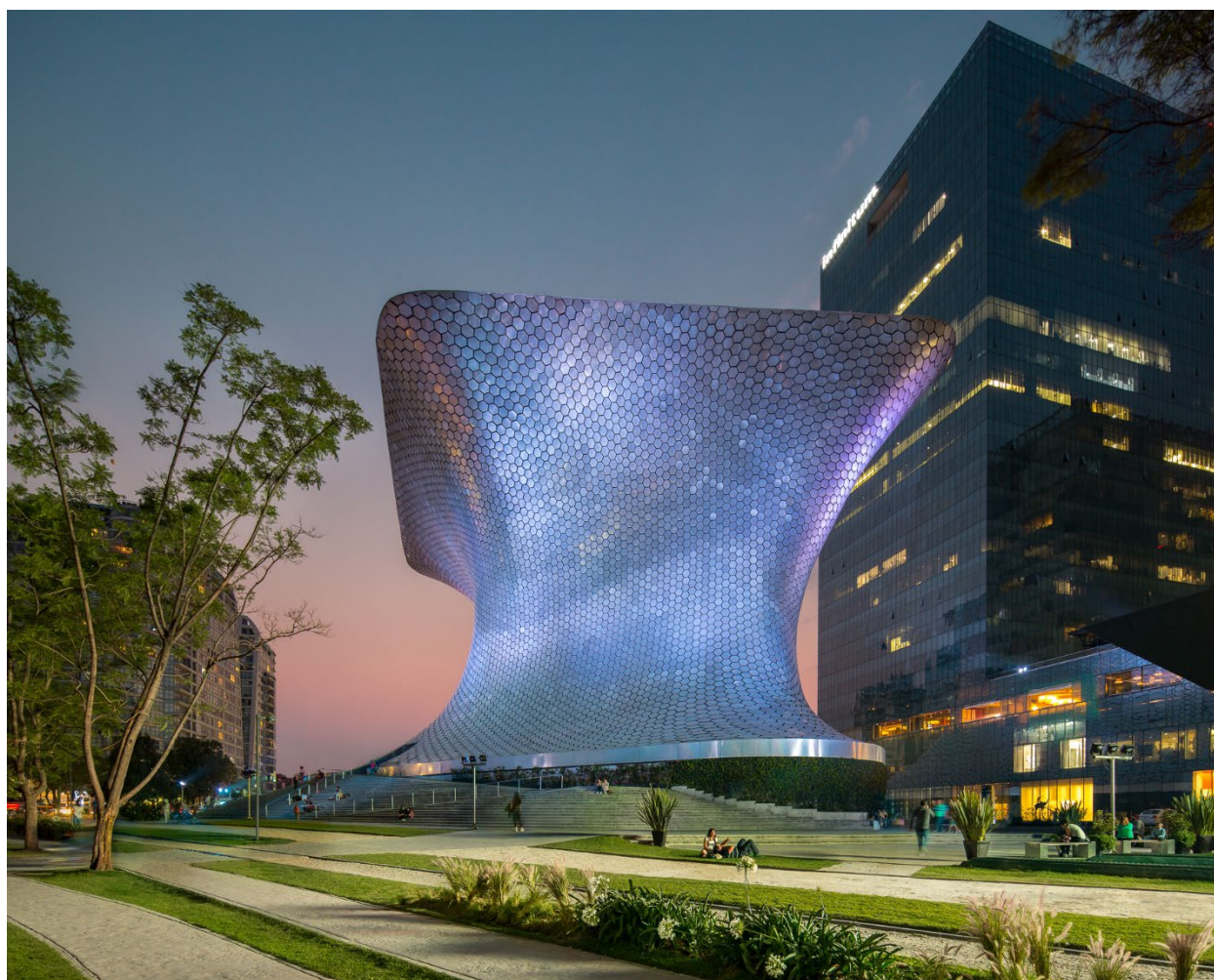

Museo Soumaya, Mexico City

In field activities

| Day | Date | Location | Logistical comments and connection to academic content | Minimum number of instructional hours |
|-----|------|----------|---|---------------------------------------|
| 0 | | | <i>*Note: The following schedule is an example of the primary details of the trip. Many activities are dependent on factors such as weather, availability of places + people, schedules of companies + firms, unforeseen opportunities, etc. Many activities require complex planning and approvals. A detailed</i> | |

| | | | | |
|----|---------------|---------------------------------------|--|---|
| | | | <i>itinerary will be determined and confirmed closer to program commencement.</i> | |
| 1 | MON May 11 | Calgary, Mexico City | Logistic: [TRAVEL DAY] YYC – MEX (plane) Academic: N/A | |
| 2 | TUE May 12 | Mexico City | Logistic: [LAUNCH] Class (Meal) Discussion + Pre-Field Research Preparation Academic: DSGN 500.1 + DSGN 500.2 | 2 |
| 3 | WED May 13 | Mexico City | Logistic: [WALKING TOUR] Zona Arqueológica de Tlatelolco, Jardín de Santiago, Zocalo + Templo Mayor, Palacio de Bellas Artes + Alameda Central, Mercado de Artesanías La Cuidadela, Parque de La Cuidadela Academic: DSGN 500.1 | 6 |
| 4 | THU May 14 | Mexico City | Logistic: [WALKING TOUR] Ricardo Legorreta's Hotel Camino Real Polanco, Parque y Castillo de Chapultepec, Museo Nacional de Antropología, Museo Soumaya + Museo Jumex Academic: DSGN 500.1 | 6 |
| 5 | FRI May 15 | Mexico City | Logistic: Class Discussion + all day Field Research Studies Academic: DSGN 500.2 | |
| 6 | SAT May 16 | Mexico City | Logistic: [DAY TRIP] Parque La Mexicana y Santa Fe Academic: DSGN 500 (x2) | 1 |
| 7 | SUN May 17 | Mexico City | Logistic: Class Discussion + all day Field Research Studies Academic: DSGN 500.2 | |
| 8 | MON May 18 | Mexico City | Logistic: [WALKING TOUR] Parque de Chapultepec (#2) + Museo Tamayo Academic: DSGN 500.1 | |
| 9 | TUE May 19 | Mexico City, Teotihuacan | Logistic: [DAY TRIP] Zona Arqueológica de Teotihuacán Academic: DSGN 500.1 | 6 |
| 10 | WED May 20 | Mexico City, Xochimilco | Logistic: [DAY TRIP] Xochimilco, Centro Historico de Coyoacán Academic: DSGN 500.1 | 6 |
| 11 | THU May 21 | Mexico City | Logistic: [WALKING TOUR] UNAM, Museo Universitario de Arte Contemporáneo (MUAC), Museo Anahuacalli Academic: DSGN 500.1 | 4 |
| 12 | FRI May 22 | Mexico City | Logistic: Class Discussion + all day Field Research Studies Academic: DSGN 500.2 | |
| 13 | SAT May 23 | Mexico City, Cuajimalpa de Morelos | Logistic: [DAY TRIP] Parque y Convento El Desierto de los Leones, Parque (Ecologico) Quetzalcoatl Academic: DSGN 500.1 | 4 |
| 14 | SUN May 24 | Mexico City | Logistic: [WALKING TOUR] Biblioteca Vasconcelos Academic: DSGN 500.1 | |
| 15 | MON May 25 | Mexico City, Querétaro | Logistic: [TRAVEL Half DAY] MEX – QRO (bus) Academic: N/A | |
| 16 | TUE May 26 | Querétaro | Logistic: [WALKING TOUR] (Santiago de) Querétaro City Center Academic: DSGN 500.1 | 6 |
| 17 | WED May 27 | Querétaro | Logistic: Class Discussion + all day Field Research Studies Academic: DSGN 500.2 | |
| 18 | THU May 28 | Querétaro, Tequisquiapan, Bernal | Logistic: [DAY TRIP] Tequisquiapan y Peña de Bernal Academic: DSGN 500.1 | 6 |
| 19 | FRI May 29 | Querétaro, Oaxaca | Logistic: [TRAVEL DAY] QRO – OAX (bus) Academic: N/A | |
| 20 | SAT May 30 | Oaxaca | Logistic: [DAY TOUR] El Tule, Mitla + Hierve el Agua Academic: DSGN 500.1 | |
| 21 | SUN May 31 | Oaxaca | Logistic: [WAKING TOUR] Oaxaca Historic Center Academic: DSGN 500.1 | 6 |

| | | | | |
|----|---------------|-------------------------|---|---|
| 22 | MON June 1 | Oaxaca | Logistic: Class Discussion + all day Field Research Studies Academic: DSGN 500.2 | |
| 23 | TUE June 2 | Oaxaca | Logistic: [DAY TOUR] Zona Arqueológica de Monte Albán Academic: DSGN 500.1 | 6 |
| 24 | WED June 3 | Oaxaca | Logistic: Class Discussion + all day Field Research Studies Academic: DSGN 500.2 | |
| 25 | THU June 4 | Oaxaca, Puebla | Logistic: [TRAVEL DAY] OAX – PBC (bus) Academic: N/A | |
| 26 | FRI June 5 | Puebla | Logistic: [DAY TOUR] Cholula Magical Town Tour Academic: DSGN 500.1 | |
| 27 | SAT June 6 | Puebla | Logistic: [WALKING TOUR] Museo Internacional del Barroco Academic: DSGN 500.1 | |
| 28 | SUN June 7 | Puebla | Logistic: Class Discussion + all day Field Research Studies Academic: DSGN 500.2 (x2) | 2 |
| 29 | MON June 8 | Puebla, Mexico City | Logistic: [Half TRAVEL DAY] PBC – MEX (bus) + [CLOSING] Class (Meal) Discussion Academic: DSGN 500.1 + DSGN 500.2 | |
| 30 | TUE 9 | Mexico City, Calgary | Logistic: [TRAVEL DAY] MEX – YYC (plane) Academic: N/A | |



Pyramid of the Moon, Teotihuacan



Parque y Castillo de Chapultepec, Mexico City